

## INSTALLATION INSTRUCTION

### ※ ACCESSORIES CHECKING

#### LIST OF THE STANDARD ACCESSORIES:

Please double-check the accessory list hereinafter and contact our company or our distributor for any unconformity.

Remarks:

1. Without affecting their performing, accessories may be changed without further notice;
2. Drawings for reference only, product size & shape refer to actual.

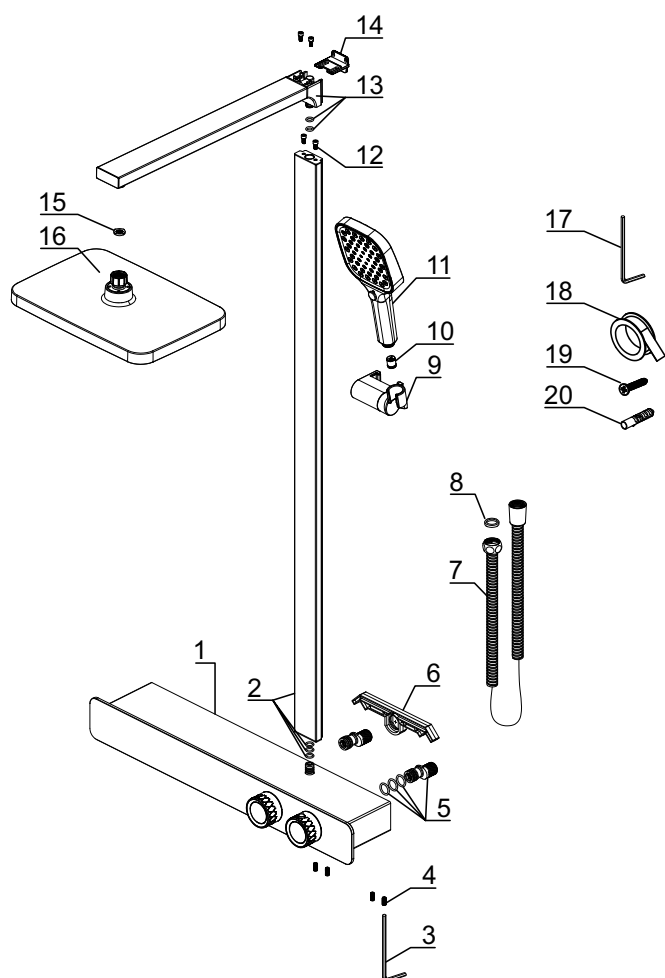

| Accessories list |                      |     |
|------------------|----------------------|-----|
| No.              | Name                 | Qty |
| 1                | Main body            | 1   |
| 2                | Pipe                 | 1   |
| 3                | Allen key            | 1   |
| 4                | Screw                | 4   |
| 5                | Set of S-unions      | 2   |
| 6                | Gradienter           | 1   |
| 7                | Shower flexible hose | 1   |
| 8                | Gasket               | 1   |
| 9                | Support              | 1   |
| 10               | Check valve          | 1   |
| 11               | Hand shower          | 1   |
| 12               | Screw                | 4   |
| 13               | Shower arm           | 1   |
| 14               | Fixed piece          | 1   |
| 15               | Gasket               | 1   |
| 16               | Shower holder        | 1   |
| 17               | Allen key            | 1   |
| 18               | Thread seal tape     | 1   |
| 19               | Screw                | 2   |
| 20               | Plastic insert       | 2   |

### ※ Installation Instructions

- ☆ Do not disassemble the main body, as it has been installed & commissioned correctly & precisely before leaving the factory;
- ☆ To avoid the faucet from jamming, do flush the water pipe before installation;
- ☆ After installation, make sure every joint safely sealed & no leaking;
- ☆ Using condition: Working pressure at 0.05-1.0MPa (including cold & hot water pressure), with applicable water temperature: 4°C-90°C;
- ☆ Make sure to connect the hot/cold inlet pipe correctly, if standing in front, hot water pipe connecting to the left & cold water pipe connecting to the right.

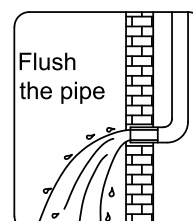
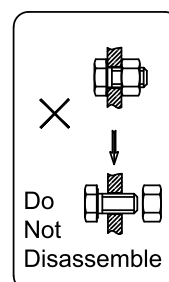

※Installation Procedures

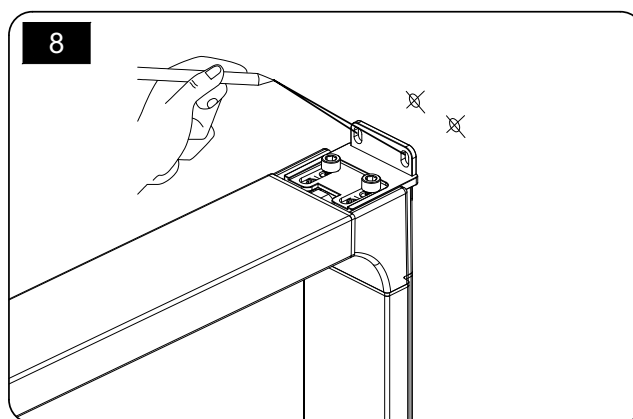
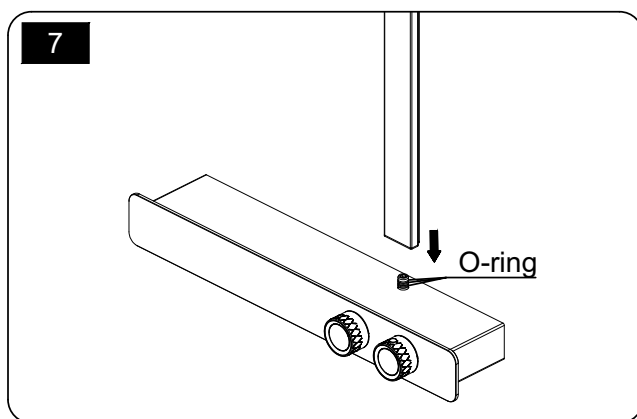
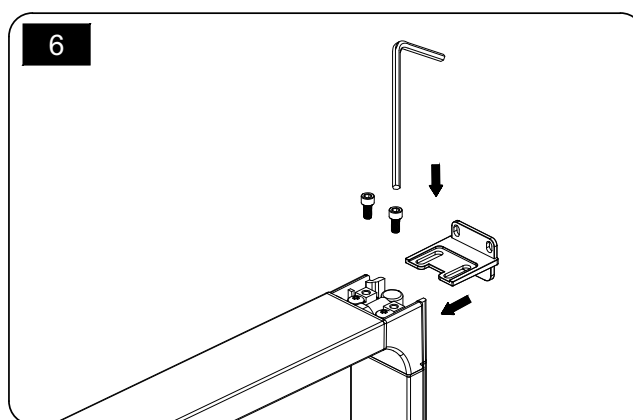
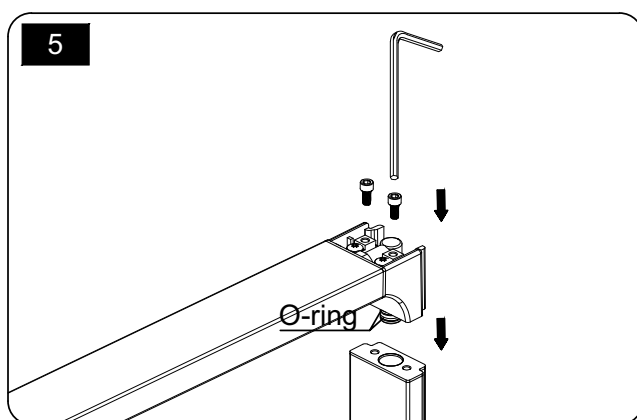
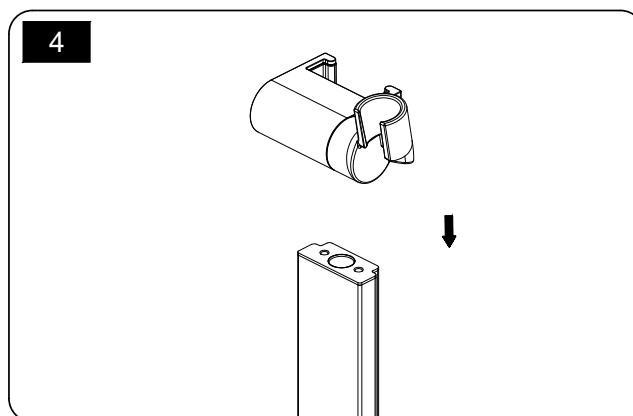
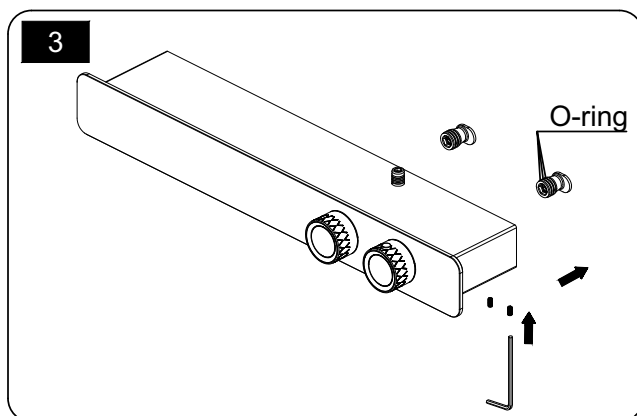
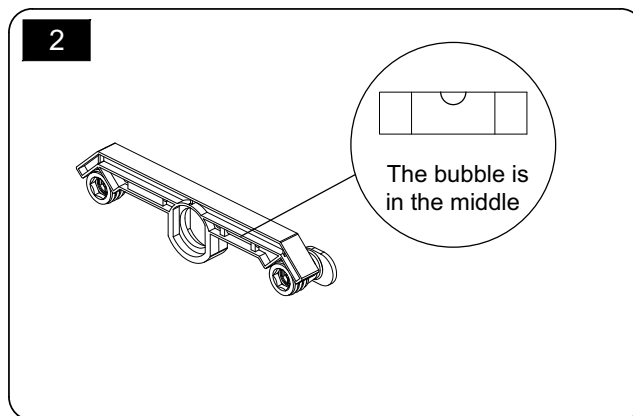
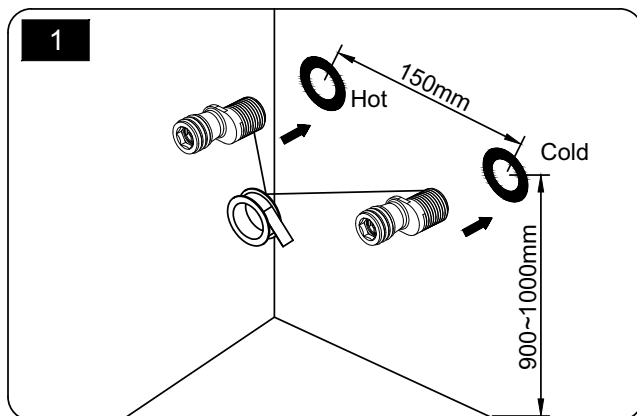

## ✕ Installation Procedures

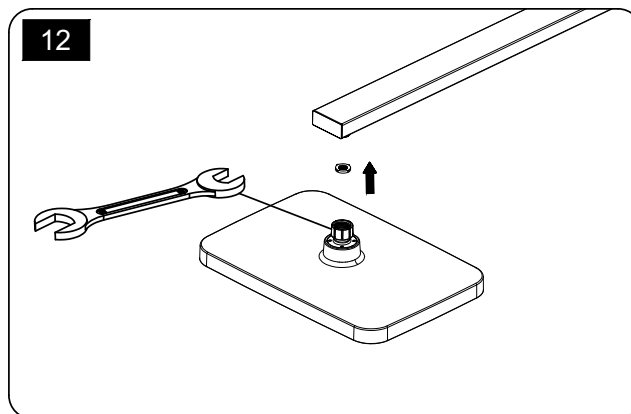
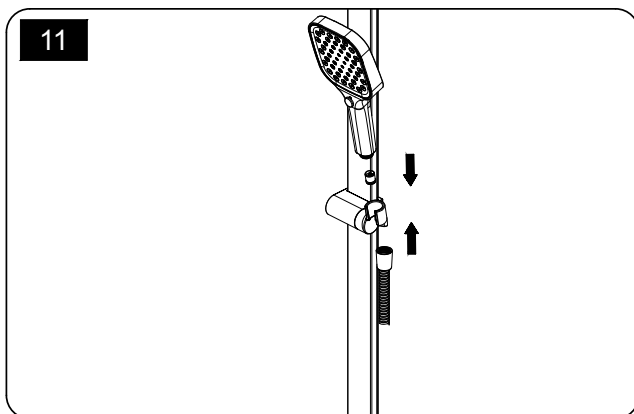
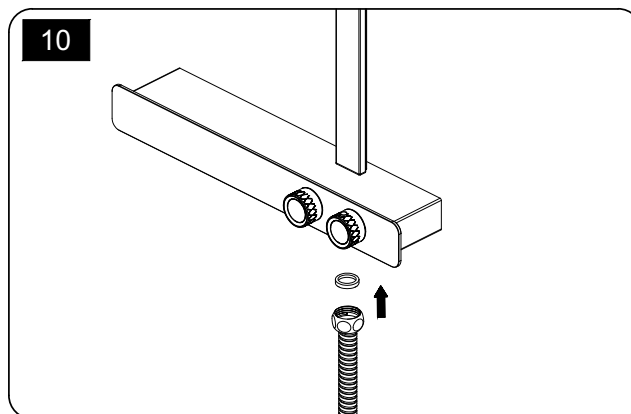
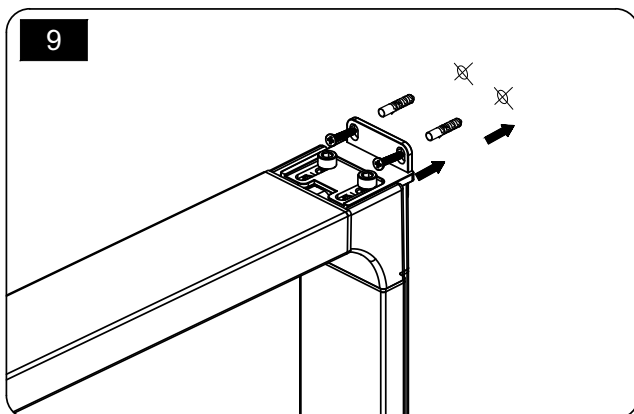

## ✕ Usage

☆ How to operate the switch/water divider handle

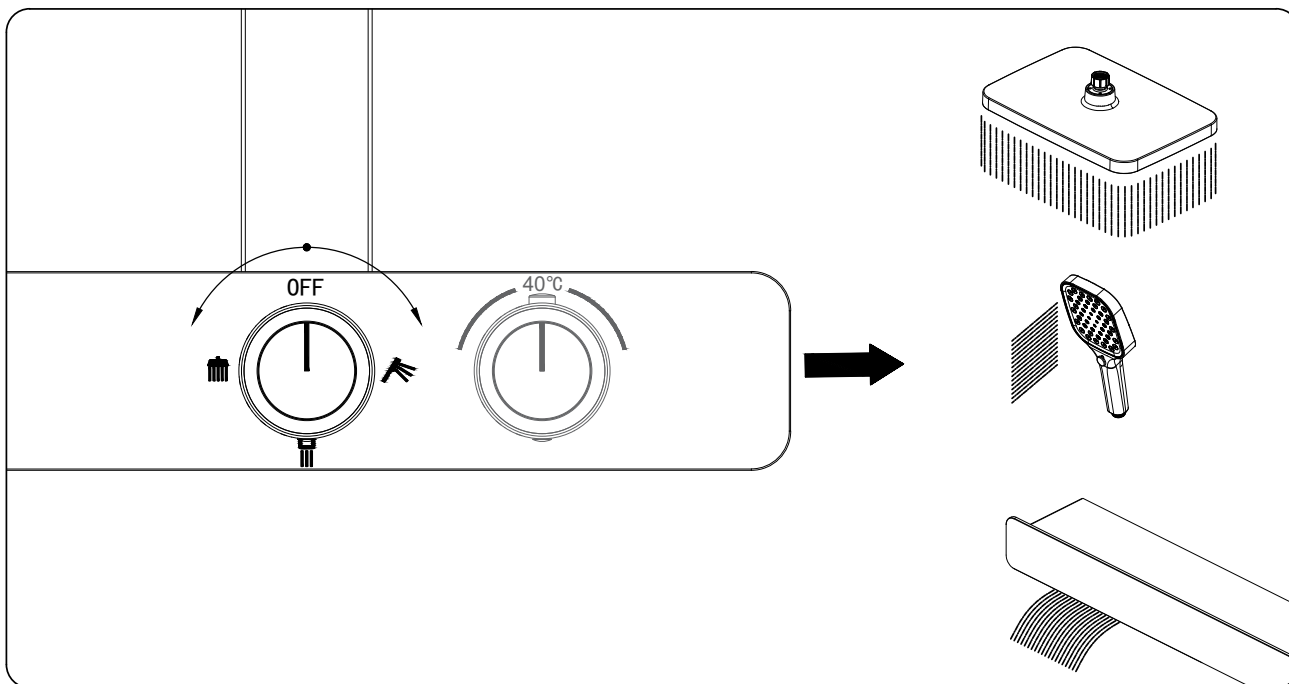

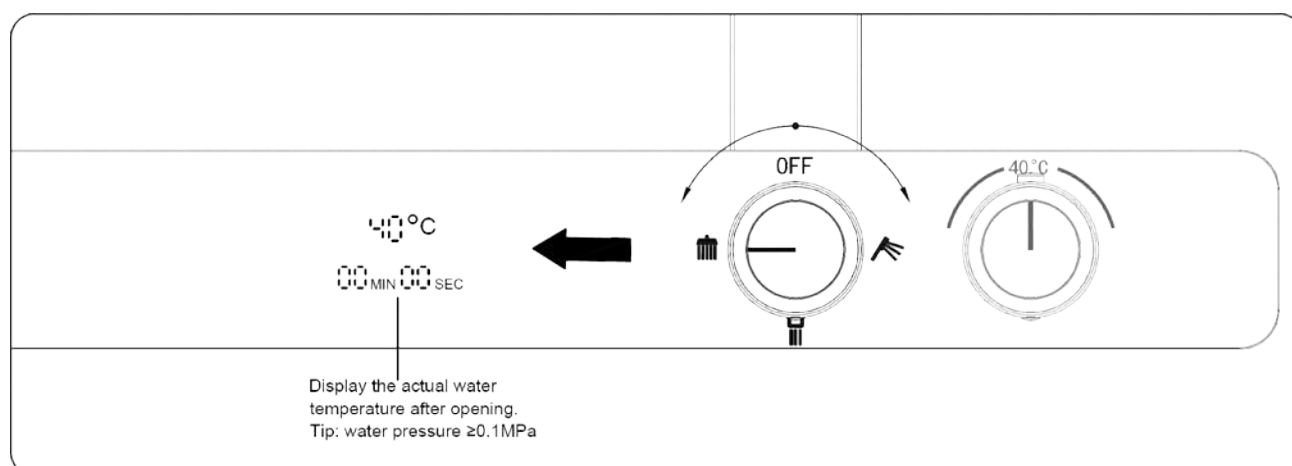

## ☆ How to operate the temperature control handle

